

smart mirror



Welcome to Your Quick Start Guide

Before You Begin

Supplied Items

Head Box:

- SmartMirror Head
- Sterilization Cap
- O-ring lubricant



Streamer Box:

- SmartMirror Streamer
- SmartMirror USB-C Female charging cable



Initial Setup

1

Download the App

You can download the SmartMirror App for iOS using the QR code below, or by searching "SmartMirror Direct" in the App Store.



2

Remove Protective Film

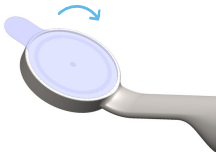

3

Charge the Streamer

To charge SmartMirror, use the original USB-C charging cable included with the device.

Plug the charging cable into any USB port and connect the USB-C Female end to the SmartMirror Streamer.



NOTE

Allow SmartMirror to charge for at least 6 hours before its first operation.

Use

1

Turn SmartMirror On

Gently insert the SmartMirror Streamer into the SmartMirror Head.

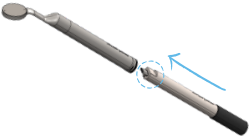



NOTE

The flat end of the Streamer should be facing the back side of the Head.

2

Pair to an iPad/iPhone

- Open the SmartMirror Direct app.
- Select  Settings then  Scan QR.
- Using the rear-facing camera on your iOS device, scan the QR code located on the bottom of the Streamer.
- Once pairing is complete, a live video stream from your SmartMirror will display on the app.



3

Turn SmartMirror Off

To turn SmartMirror off, simply pull the SmartMirror Streamer out of the SmartMirror Head. The device will shut off automatically.

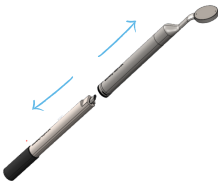

For the full User Manual, FAQs and tutorials, please visit the Support page on our website or scan the QR code below.



App Overview

When SmartMirror and an iOS device are successfully connected, the app's home screen is displayed. You can now begin exploring, taking images and videos, and adjusting the light intensity.

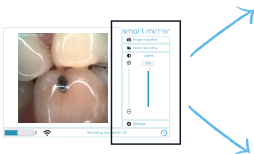

NOTE

Media files are saved to dedicated albums in Photos on the iOS device.



TIP

When taking images or video, set light intensity to 100%.

When using as a mirror, adjust the light to suit your needs.



Image snapshot



Video recording



Lights



100%



Settings

Maintenance

1

Insert the Sterilization Cap

Before cleaning or sterilizing the SmartMirror Head, make sure to lightly lubricate the Sterilization Cap O-rings using the enclosed O-ring lubricant. Then insert the Cap.

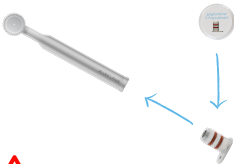

CAUTION

Fully insert the Sterilization Cap into the SmartMirror Head prior to any cleaning/sterilization.

2

Disinfect/Clean/Sterilize the Head

The SmartMirror Head can be reprocessed using common dental practices such as autoclaving or cold sterilization.

Autoclave settings:
250° F / 121° C for 30
minutes.



CAUTION

DO NOT immerse in
ultrasonic bath.



3

Clean/Disinfect the Streamer

The SmartMirror Streamer can be disinfected and cleaned using disinfectant wipes.



WARNING

DO NOT immerse the SmartMirror Streamer in any liquid.

DO NOT autoclave the SmartMirror Streamer.

DO NOT wipe the USB-C connector on the Streamer.

Meet SmartMirror Edge!

Get More Out of Your Mirror



- Enhanced functionality
- Practice management software integration
- Streamlined workflow
- Seamless pairing
- Charging station

Contact us to learn more.
info@smartmirror.dental



Dental SmartMirror, Inc.
1101 W Monroe St, Suite 200
Chicago, IL 60607 USA
info@smartmirror.dental

www.smartmirror.dental

Join our Facebook community:
SmartMirror User Forum



© 2021 Dental SmartMirror Inc.
All rights reserved.

